

n **Vf**
PAGE 307

DIN 851



WTM (d11)

Ø mm	10~18	19~30	32~40
tol. D µ	-50 / -160	-65 / -195	-80 / -240

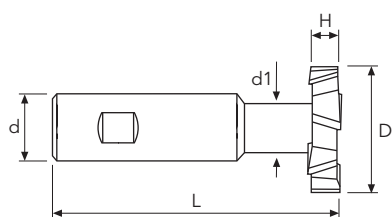

D(d11)	d(h6)	d1	H(d11)	L	Z	Stock
mm 12.5	10	5	6	57	6	●
16	10	6.5	8	62	6	●
18	12	8	8	70	6	●
19	12	8	9	71	6	●
21	12	10	9	74	6	●
22	12	10	10	75	6	●
25	16	12	11	82	6	●
28	16	13	12	83	6	●
32	16	15	14	90	8	●
36	25	17	16	103	8	●
40	25	19	18	108	8	○

● stock standard ○ non-standard stock ■ stock exhaustion